

Bisagra 'Combi' Zamak

Fija

Die-cast Zinc Combi Hinge

Non-detachable

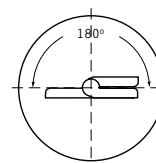
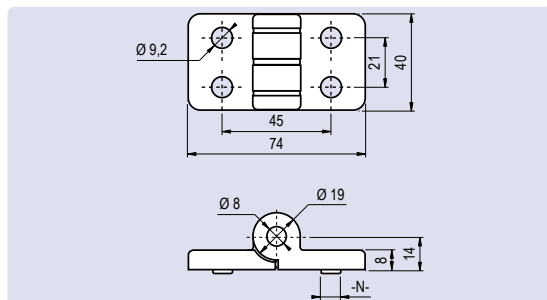
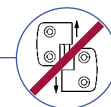

Descripción Para conectar paneles o perfiles de aluminio

Material Zamak

Recubrimiento Epoxy negro
(otros acabados bajo consulta)

Carga Máx. 250 Nm

Description To connect panels or aluminium profiles

Material Die-cast zinc

Surface Black powder coated
(other surfaces on request)

Max. Load 250 Nm

	Centradores Traseros Locating Pins	A1 [mm]	A2 [mm]	Peso [g] Weight [g]	Referencia Part Nº
Bisagra 40/40	sin without	22,5	22,5	189,0	FBICZ-40.40F
Hinge 40/40	para Canal de 8 for Slot 8	22,5	22,5	189,0	FBICZ-40.40F.8
	para Canal de 10 for Slot 10	22,5	22,5	189,0	FBICZ-40.40F.10
Bisagra 40/45	sin without	22,5	25,0	189,0	FBICZ-40.45F
Hinge 40/45	para Canal de 8 for Slot 8	22,5	25,0	189,0	FBICZ-40.45F.8
	para Canal de 10 for Slot 10	22,5	25,0	189,0	FBICZ-40.45F.10
Bisagra 45/45	sin without	25,0	25,0	189,0	FBICZ-45.45F
Hinge 45/45	para Canal de 8 for Slot 8	25,0	25,0	189,0	FBICZ-45.45F.8
	para Canal de 10 for Slot 10	25,0	25,0	189,0	FBICZ-45.45F.10