

# TORNILLOS EN 'T'

## Tornillo para ranura en 'T' DIN 787 c. 12,9

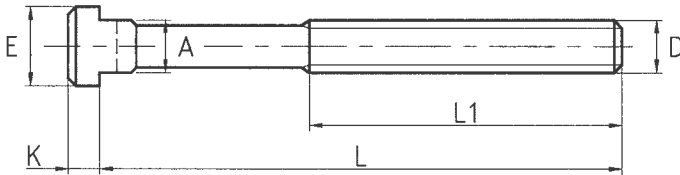

Acero forjado  
Bonificado y pavonado.  
Calidad 12.9.

Referencia	D		L	L1	E	K	A	Gram.
787+1010.40	M10	10	40	30	15	6	9,7	30
787+1010.50			50	35				40
787+1010.80			80	50				60
787+1010.100			100	60				70
787+1212.50	M12	12	50	35	18	7	11,7	60
787+1212.63			63	40				65
787+1212.80			80	55				75
787+1212.100			100	65				90
787+1212.125			125	75				110
787+1212.200	M12	12	200	120	22	8	13,7	160
787+1214.50			14	50				35
787+1214.63		63		45				80
787+1214.80		80		55				100
787+1214.100		100		65				110
787+1214.125		125		75				120
787+1214.200		200		120				180
787+1616.63		M16	16	63				45
787+1616.100	100			65	180			
787+1616.160	160			100	270			
787+1616.250	250			150	380			
787+1618.63	M16	18	63	45	28	10	17,7	160
787+1618.80			80	55				185
787+1618.100			100	65				203
787+1618.125			125	85				230
787+1618.160			160	100				280
787+1618.250			250	150				430

Referencia	D		L	L1	E	K	A	Gram.
787+2020.80	M20	20	80	55	32	12	19,7	290
787+2020.125			125	85				390
787+2020.200			200	125				550
787+2020.315			315	190				800
787+2022.80			22	80				55
787+2022.125	125	85		428				
787+2022.200	200	125		570				
787+2022.315	315	190		820				
787+2424.100	M24	24	100	70	40	16	23,7	540
787+2424.160			160	110				770
787+2424.250			250	150				960
787+2424.400			400	240				1410
787+2428.100	M24	28	100	70	44	18	27,7	650
787+2428.160			160	110				800
787+2428.250			250	150				1120
787+2428.400			400	240				1490

Otras medidas disponibles bajo consulta.