



Material
Acero tratado.

Norma
ANSI B 18.3

D	5/16NC	5/16NF	3/8NC	3/8NF	7/16NC	1/2NC	1/2NF	5/8NC	3/4NC
D1 min.	0.589	0.589	0.704	0.704	0.755	0.857	0.857	1.065	1.293
D2 max.	0.342	0.342	0.405	0.405	0.467	0.530	0.530	0.655	0.780
K	0.205	0.205	0.241	0.241	0.242	0.260	0.260	0.335	0.410
S	3/16	3/16	7/32	7/32	1/4	5/16	5/16	3/8	3/8
Hilos/ "	18	24	16	24	14	13	20	11	10
L1	Ver páginas 38 y 39								
Par de apriete (Nm)**	28	28	45	45	68	135	135	226	452
L	1/2	1/2	1/2	5/8	3/4	3/4	3/4	1 1/4	1 1/2
	5/8	5/8	5/8	3/4	1	1	1	1 1/2	1 3/4
	3/4	3/4	3/4	1	1 1/4	1 1/4	1 1/4	1 3/4	2
	1	1	1	1 1/4	1 1/2	1 1/2	1 1/2	2	2 1/2
	1 1/4	1 1/4	1 1/4	1 1/2		1 3/4	1 3/4	2 1/4	3
	1 1/2	1 1/2	1 1/2			2	2	2 1/2	
	1 3/4		1 3/4			2 1/2		3	
	2		2						
2 1/4		2 1/4							
2 1/2		2 1/2							
		3							

	1 U
	10 U
	25 U
	50 U
	100 U
	200 U

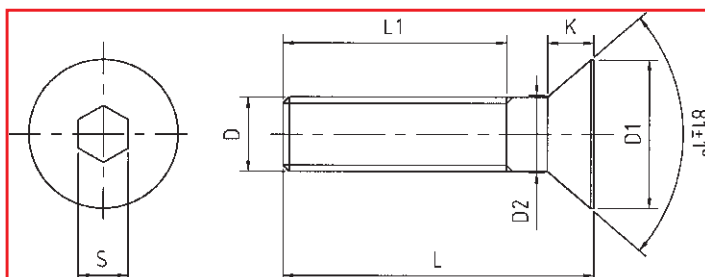

Propiedades mecánicas:

Dureza: ≤ 1/2 39-43 Hrc.

≥ 1/2 38-42 Hrc.

Alargamiento mínimo a la rupt

Alargamiento mínimo a la ruptura : 8 %

Temperaturas de empleo: -29 ° a + 204 °C

** Valores recomendados para los tornillos Holo-Krome.