

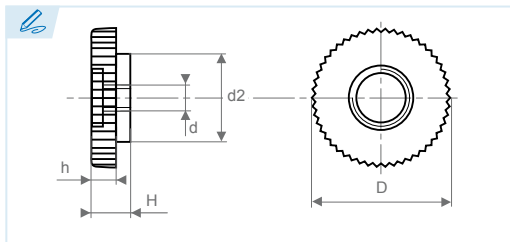

DIN 467*



Tuerca de nylon con moleteado fino, forma baja
Knurled nuts, flat form, fine knurling
Écrou moleté cranté, type bas
Porca de nylon com serrilhado fino, forma baixa

***Similar a DIN 467**
**Similar to DIN 467*
**Similaire DIN 467*
**Semelhante DIN 467*

Material estándar: Poliamida
Standard material: Polyamide
Matière standard: Polyamide
Material padrão: Poliamida

Color: Blanco
Colour: White
Couleur: Blanc
Cor: Branco

Colores RAL y especiales bajo consulta.
RAL and special colours upon request.
Sur demande autres couleurs RAL et modèles.
Cores RAL e especiais, disponíveis sob consulta.

Ref.	D	d	d2	H	h
467FN-12-3	12	M3	8,5	5,0	3,5
467FN-14-4	14	M4	8,5	5,0	3,5
467FN-16-4	16	M4	10,0	6,0	4,5
467FN-16-5	16	M5	10,0	6,0	4,5
467FN-16-6	16	M6	10,0	6,0	4,5

Ref.	D	d	d2	H	h
467FN-19-5	19	M5	10,0	7,5	6,0
467FN-19-6	19	M6	10,0	7,5	6,0
467FN-20-4	20	M4	10,0	7,5	6,0
467FN-24-8	24	M8	13,0	7,5	6,0

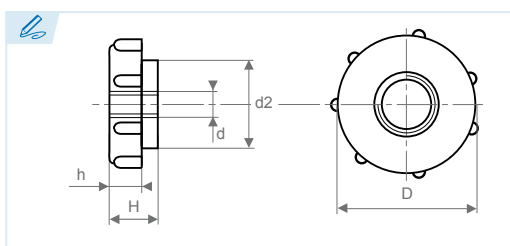

Tuerca de nylon con moleteado grueso, forma baja
Knurled nuts, flat form, rough knurling
Écrou moleté épais, type bas
Porca de nylon com serrilhado grosso, forma baixa

***Similar a DIN 467**
**Similar to DIN 467*
**Similaire DIN 467*
**Semelhante DIN 467*

Material estándar: Poliamida
Standard material: Polyamide
Matière standard: Polyamide
Material padrão: Poliamida

Color: Blanco
Colour: White
Couleur: Blanc
Cor: Branco

Colores RAL y especiales bajo consulta.
RAL and special colours upon request.
Sur demande autres couleurs RAL et modèles.
Cores RAL e especiais, disponíveis sob consulta.

Ref.	D	d	d2	H	h
467GN-16-4	16	M4	10	6,0	4,5
467GN-16-5	16	M5	10	6,0	4,5
467GN-16-6	16	M6	10	6,0	4,5
467GN-20-4	20	M4	10	6,5	5,0

Ref.	D	d	d2	H	h
467GN-20-5	20	M5	10	6,5	5,0
467GN-20-6	20	M6	10	6,5	5,0
467GN-24-5	24	M5	10	7,5	5,7
467GN-24-6	24	M6	10	7,5	5,7