

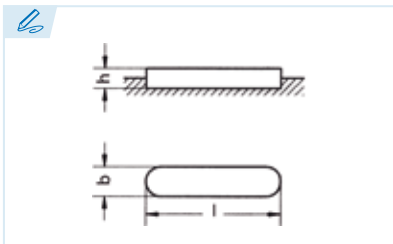

DIN 6885 / DIN 6886



DIN 6885 A

**Chaveta paralela - Forma A**  
Parallel Key - Form A  
Clavette parallèle - Forme A  
Chaveta paralela - Forma A

**Extremos redondeados (2)**  
Round Ends (2)  
Bouts ronds (2)  
Extremidades arredondadas (2)

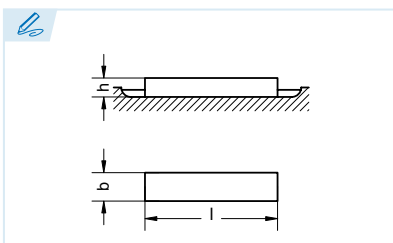

DIN 6885 B

**Chaveta paralela - Forma B**  
Parallel Key - Form B  
Clavette parallèle - Forme B  
Chaveta paralela - Forma B

**Extremos rectos (2)**  
Square Ends (2)  
Bouts droits (2)  
Extremidades retas (2)

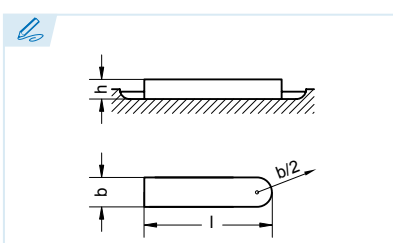

DIN 6885 AB

**Chaveta paralela - Forma AB**  
Parallel Key - Form AB  
Clavette parallèle - Forme AB  
Chaveta paralela - Forma AB

**Extremo redondeado (1) y extremo recto (1)**  
Round End (1) and Square End (1)  
Bout rond (1) et bout droit (1)  
Extremidade arredondada (1) e extremidade reta (1)

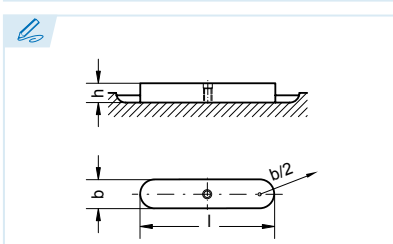

DIN 6885 AE

**Chaveta paralela - Forma AE**  
Parallel Key - Form AE  
Clavette parallèle - Forme AE  
Chaveta paralela - Forma AE

**Extremos redondeados (2) y agujero para extracción**  
Round Ends (2) and a Hole for Extraction  
Bouts ronds (2) et trou pour démontage  
Extremidades arredondadas (2) e furo para extração

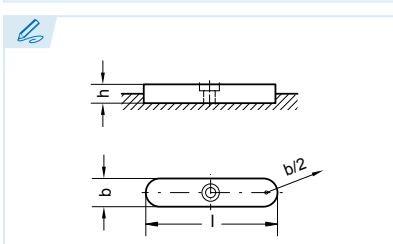

DIN 6885 C

**Chaveta paralela - Forma C**  
Parallel Key - Form C  
Clavette parallèle - Forme C  
Chaveta paralela - Forma C

**Extremos redondeados (2) y tornillo de retención**  
Round Ends (2) and a Retention Bolt  
Bouts ronds (2) et taraudage pour vis de retenue  
Extremidades arredondadas (2) e parafuso de retenção

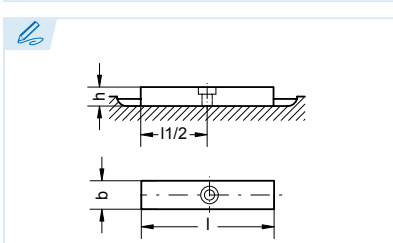

DIN 6885 D

**Chaveta paralela - Forma D**  
Parallel Key - Form D  
Clavette parallèle - Forme D  
Chaveta paralela - Forma D

**Extremos rectos (2) y tornillo de retención**  
Square Ends (2) and a Retention Bolt  
Bouts droits (2) et taraudage pour vis de retenue  
Extremidades retas (2) e parafuso de retenção

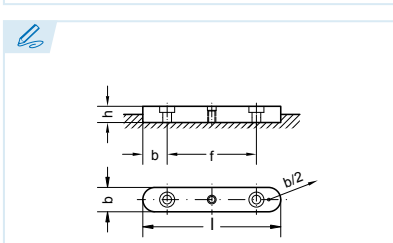

DIN 6885 E

**Chaveta paralela - Forma E**  
Parallel Key - Form E  
Clavette parallèle - Forme E  
Chaveta paralela - Forma E

**Extremos redondeados (2), tornillos de retención (2) y extractor (1)**  
Round Ends (2), Retention Bolts (2) and an Extractor (1)  
Bouts ronds (2), taraudages pour vis de retenue (2) et trou pour démontage (1)  
Extremidades arredondadas (2), parafusos de retenção (2) e extrator (1)

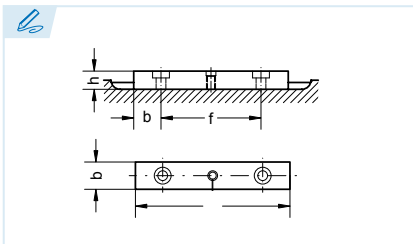

**DIN 6885 F**

**Chaveta paralela - Forma F**

Parallel Key - Form F  
Clavette parallèle - Forme F  
Chaveta paralela - Forma F

**Extremos rectos (2), tornillos de retención (2) y extractor (1)**  
Square Ends (2), Retention Bolts (2) and an Extractor (1)  
Bouts droits (2), taraudages pour vis de retenue (2) et trou pour démontage (1)  
Extremidades retas (2), parafusos de retenção (2) e extrator (1)

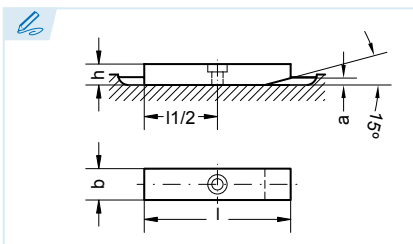

**DIN 6885 G**

**Chaveta paralela - Forma G**

Parallel Key - Form G  
Clavette parallèle - Forme G  
Chaveta paralela - Forma G

**Extremos rectos (2), tornillo de retención (1) y chaflán (1)**  
Square Ends (2), Retention Bolts (1) and a Chamfer (1)  
Bouts droits (2), taraudage pour vis de retenue (1) et chanfrein d'entrée (1)  
Extremidades retas (2), parafusos de retenção (1) e chanfro (1)

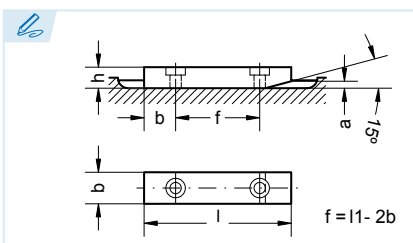

**DIN 6885 H**

**Chaveta paralela - Forma H**

Parallel Key - Form H  
Clavette parallèle - Forme H  
Chaveta paralela - Forma H

**Extremos rectos (2), tornillos de retención (2) y chaflán (1)**  
Square Ends (2), Retention Bolts (2) and a Chamfer (1)  
Bouts droits (2), taraudages pour vis de retenue (2) et chanfrein d'entrée (1)  
Extremidades retas (2), parafusos de retenção (2) e chanfro (1)

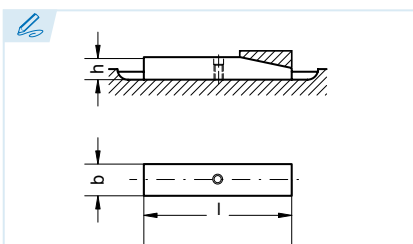

**DIN 6885 J**

**Chaveta paralela - Forma J**

Parallel Key - Form J  
Clavette parallèle - Forme J  
Chaveta paralela - Forma J

**Extremos rectos (2), agujero para pasador elástico (1) y chaflán (1)**  
Square Ends (2), Spring Pin Hole (1) and a Chamfer (1)  
Bouts droits (2), trou central pour goupille élastique (1) et chanfrein d'entrée (1)  
Extremidades retas (2), furo para passador elástico (1) e chanfro (1)

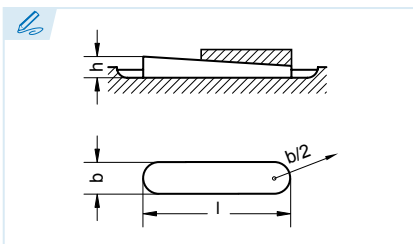

**DIN 6886 A**

**Chaveta plana inclinada - Forma A**

Taper Key - Form A  
Clavette inclinée - Forme A  
Chaveta plana inclinada - Forma A

**Extremos redondeados (2)**  
Round Ends (2)  
Bouts ronds (2)  
Extremidades arredondadas (2)

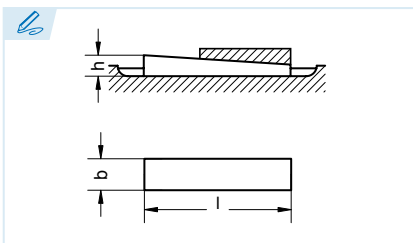

**DIN 6886 B**

**Chaveta plana inclinada - Forma B**

Taper Key - Form B  
Clavette inclinée - Forme B  
Chaveta plana inclinada - Forma B

**Extremos rectos (2)**  
Square Ends (2)  
Bouts droits (2)  
Extremidades retas (2)



**Chavetas especiales**

Special Keys  
Clavettes spéciales  
Chavetas especiais

**Podemos ofrecer chavetas especiales en distintas formas y materiales, desde una unidad a largas series.**  
We can offer special keys in different forms and materials that range from one unit to large series.  
Sur demande clavettes spéciales ou sur plan, de l'unité à la grande série.  
Podemos oferecer chavetas especiais em diferentes formas e materiais, desde uma única unidade até grandes séries.