

E4130

PATENTE REGISTRADA
PATENTS FILED

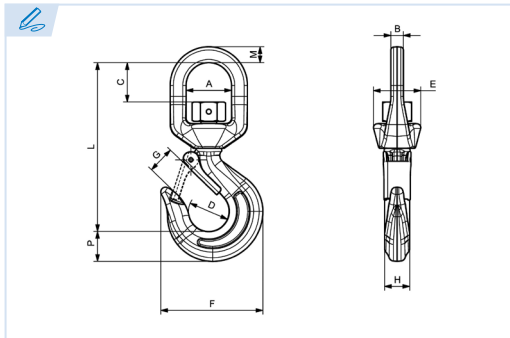

BREVETS DÉPOSÉS
PATENTE REGISTRADA



Gancho giratorio con pestillo

Swivel hook with latch

Crochet à émerillon avec linguet

Gancho com dispositivo giratório com patilha de segurança

Grado 80

Grade 80

Grade 80

Grau 80

Conforme a la directiva europea 2006/42/CE

In accordance with the new european directive 2006/42/CE.

Conforme à la directive européenne machines 2006/42/CE.

Conforme a norma europeia 2006/42/CE.

ES EN FR PT

CMU Carga máxima de utilización

Working load limit

Charge maximale d'utilisation

Carga máxima de trabalho

T Tonelada

Tone

Tonne

Tonelada

| Ref. | Ø Cadena | | CMU | A | B | C | D | E | F | G | H | L | M | P | Kg. |
|----------|----------|-------|--------|----|------|----|----|----|-----|------|------|-----|------|------|------|
| E4130-6 | 6 | 1/4" | 1,25 T | 38 | 10.5 | 37 | 33 | 40 | 82 | 21 | 17 | 137 | 13 | 22 | 0,78 |
| E4130-7 | 7 | 9/32" | 1,6 T | 38 | 10.5 | 35 | 35 | 40 | 87 | 24 | 19 | 144 | 13 | 23.5 | 0,94 |
| E4130-8 | 8 | 5/16" | 2,5 T | 47 | 13 | 43 | 38 | 49 | 98 | 25.5 | 24 | 171 | 16.5 | 28 | 1,58 |
| E4130-10 | 10 | 3/8" | 3,2 T | 47 | 13 | 41 | 42 | 49 | 109 | 28.5 | 26 | 176 | 16.5 | 31 | 1,9 |
| E4130-13 | 13 | 1/2" | 5,4 T | 58 | 15.5 | 52 | 51 | 61 | 134 | 36.5 | 31.5 | 214 | 20 | 38.5 | 3,65 |
| E4130-16 | 16 | 5/8" | 8 T | 71 | 17.5 | 68 | 63 | 72 | 168 | 45.5 | 39 | 268 | 26 | 50.5 | 5,87 |
| E4130-19 | 19 | 3/4" | 11,5 T | 81 | 22 | 70 | 76 | 83 | 202 | 55.5 | 45 | 311 | 29 | 61 | 9,75 |

