



**Bisagra para tareas pesadas**

*Heavy-duty hinge  
Charnière renforcée  
Dobradiça para tarefas pesadas*

**Material: Acero inoxidable SS 316**

*Material: Stainless steel SS 316  
Matériau: Acier inoxydable SS 316  
Material: Aço inoxidável SS 316*

**Pasador: Acero inoxidable SS 316**

*Bolt: Stainless steel SS 316  
Axe: Acier inoxydable SS 316  
Passador: Aço inoxidável SS 316*

**Acabado: Sin recubrimiento**

*Surface: Plain  
Finition: Brut  
Acabamento: Sem revestimento*

ES EN FR PT

**FA** Fuerza Axial máxima (N)  
max. Maximum Axial Force (N)  
Charge axiale maximale (N)  
Força Axial máxima (N)

**FR** Fuerza Radial máxima (N)  
max. Maximum Radial Force (N)  
Charge radiale maximale (N)  
Força Radial máxima (N)

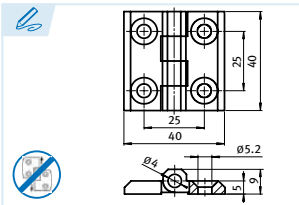

**40x40**

Ref.	FA max.	FR max.	gr.
FBIFS-40-40	700	1.200	61

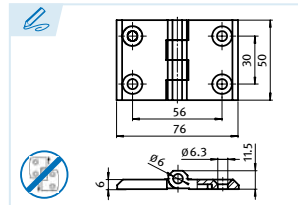

**50x76**

Ref.	FA max.	FR max.	gr.
FBIFS-50-76	550	1.000	146

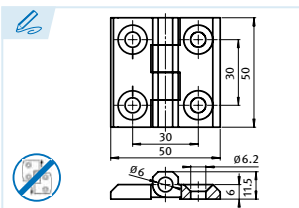

**50x50**

Ref.	FA max.	FR max.	gr.
FBIFS-50-50	900	1.600	95

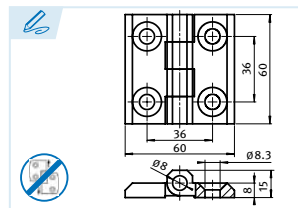

**60x60**

Ref.	FA max.	FR max.	gr.
FBIFS-60-60	1.200	2.000	222

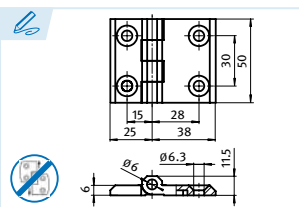

**50x63**

Ref.	FA max.	FR max.	gr.
FBIFS-50-63	900	1.600	122



Bisagra para tareas pesadas. La fijación se realiza por la parte frontal mediante tornillos avellanados.

*Heavy-duty hinge. Fastening is from the front, using countersunk screws.*

*Charnière pour utilisation intensive. L'assemblage se réalise de face avec des vis tête fraisée.*

*Dobradiça para tarefas pesadas. A fixação é realizada pela parte frontal mediante parafusos rebaxados.*

