



Bisagra metálica

Metal hinge
Charnière métallique
Dobradiça metálica

Material: Zamak
Material: Die-cast zinc
Matériau: Zinc injecté
Material: Zamak

Pasador: Acero inoxidable
Bolt: Stainless steel
Axe: Acier inoxydable
Passador: Aço inoxidável

Acabado: Expositivo negro
Surface: Black powder coated
Finition: Peinture époxy noire
Acabamento: Epóxi preto

ES EN FR PT

FA Fuerza Axial máxima (N)
max. Maximum Axial Force (N)
Charge axiale maximale (N)
Força Axial máxima (N)

FR Fuerza Radial máxima (N)
max. Maximum Radial Force (N)
Charge radiale maximale (N)
Força Radial máxima (N)

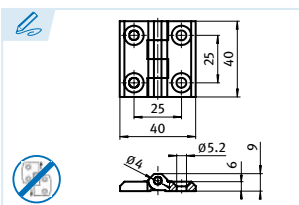

40x40

Ref.	FA max.	FR max.	gr.
FBIZ-40-40	800	1.500	45

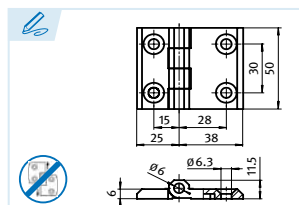

50x63

Ref.	FA max.	FR max.	gr.
FBIZ-50-63	1.400	2.200	106

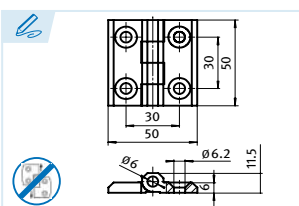

50x50

Ref.	FA max.	FR max.	gr.
FBIZ-50-50	1.000	1.800	90

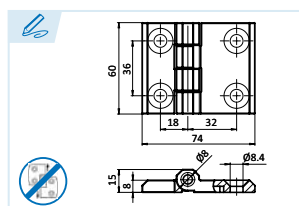

60x74

Ref.	FA max.	FR max.	gr.
FBIZ-60-74	1.200	2.200	196

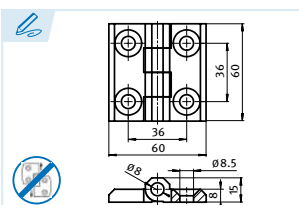

60x60

Ref.	FA max.	FR max.	gr.
FBIZ-60-60	1.400	2.200	168

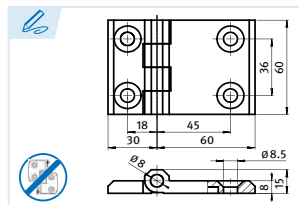

60x90

Ref.	FA max.	FR max.	gr.
FBIZ-60-90	800	2.200	218

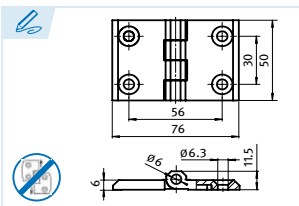

50x76

Ref.	FA max.	FR max.	gr.
FBIZ-50-76	600	1.800	145

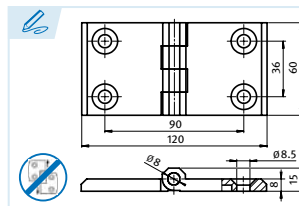

60x120

Ref.	FA max.	FR max.	gr.
FBIZ-60-120	700	2.200	281

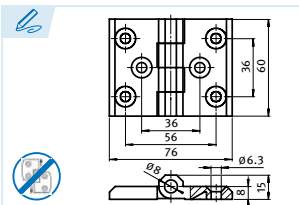

60x76

Ref.	FA max.	FR max.	gr.
FBIZ-60-76	1.200	2.200	197

- Otros acabados y colores bajo consulta.
- Other surfaces and further colors on request.
- Sur demande autres finitions et couleurs.
- Outros acabamentos e cores disponíveis sob consulta.

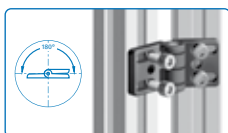

Bisagra fuerte para aplicaciones a izquierda y derecha. La fijación se realiza por la parte frontal mediante tornillos avellanados.
Sturdy hinge for right and left application. Fastening is from the front, using countersunk screws.
Charnière renforcée pour applications gauche et droite. L'assemblage se réalise de face avec des vis tête fraisée.
Dobradiça forte para aplicações à esquerda e direita. A fixação é realizada pela parte frontal mediante parafusos rebaixados.